

elfa® INSTALLATION GUIDELINES FOR VENTILATED SHELVING FOR PROFESSIONAL INSTALLERS

TOOLS REQUIRED FOR INSTALLATION OF elfa® SHELVING:

- Power drill with wood (1/8") and sheet rock (3/8") bits
- Level
- Hammer or Rubber Mallet
- Ladder
- Jig Saw or Sawz-all with bi-metal blades to cut track and shelves to length
- Tape Measure
- Refer to the Assembly and Install Guide for specific instructions

INSTALLATION OF THE TOP-TRACK

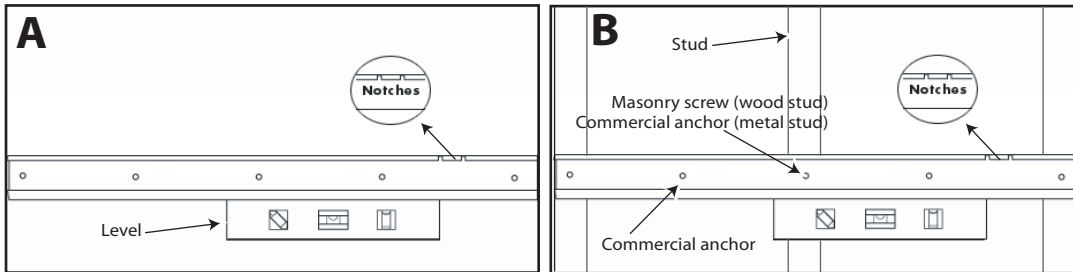

Example: Dense book storage, saline solution, multiple car batteries

TOP-TRACKS have a top and a bottom.

The **TOP** has the notches - elfa® Hanging Standards insert through the notches then slide.

- Place **TOP-TRACK** at desired height (refer to your drawing). Place level at the bottom of the track to ensure it is level. **(Figure A)**
- **elfa Easy Hang** track is designed with anchoring holes spaced every 8 inches to mount on open sheet rock; or align with studs for heavier storage applications. We recommend stud mounted support or blocking for shelf loads exceeding 75 lbs. per linear foot or where total loads on a 24" wide shelving section exceeds 500 lbs. Anchors to use - **COMMERCIAL** anchors (red - Article #471698). For very heavy storage applications, you should use wood screws (Article #470698) to wood studs and Commercial anchors (Article #471698) with metal studs. **(Figure B)**
- While leveling your Top Track, mark all the holes with a pencil. Holes are set 8" apart. Set the Top Track aside, then drill all marked holes with a 1/8" or 3/8" drill bit (depending on wall composition).
- Place the Top Track on the wall and insert and tighten all the screws using a power drill with appropriate bit. **IMPORTANT!!! Use power drill at low speed to firmly seat plastic molly and to avoid stripping the screw heads. The anchor must seat firmly to the back of the sheet rock.**



Commercial anchors



Masonry/wood screws

HANGING STANDARDS, BRACKETS and SHELVES

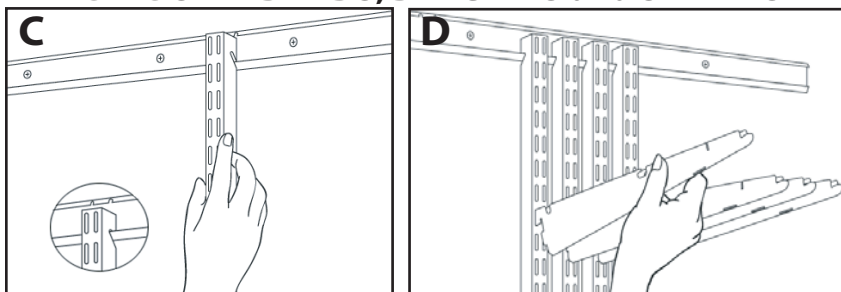

HANGING STANDARDS AND BRACKETS

- Insert Hanging Standards in the TOP TRACK notches. **(Figure C)** Group Hanging Standards together and insert Brackets at appropriate height based on your drawing. **(Figure D)** Space out hanging standards to approximate size of Shelf to be inserted.

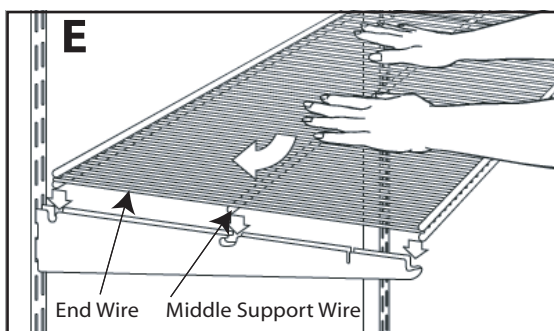

INSTALLING VENTILATED SHELF

- **Ventilated Shelves have a top and a bottom - the middle support wire is connected at the bottom of the shelf**
- Install the Ventilated Shelves from shortest to longest, regardless of their location in the space. This will help in measuring.
- Lock the Shelf into place by pressing down on the middle of the Shelf and pushing toward the wall. **(Figure E)**

TO REMOVE A SHELF

- Hold the Hanging Standard steady with one hand. Place the other hand at the back of the Shelf. Pull up and forward on the shelf to release.

